

HTP067

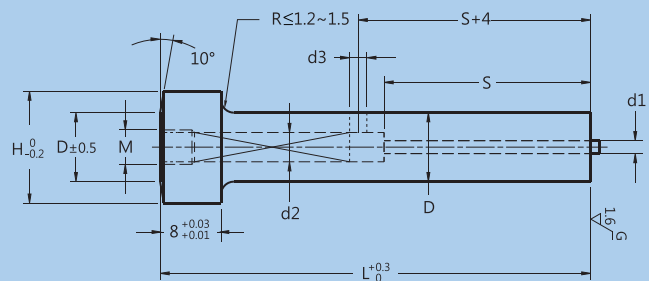

Type 品名	Material 材質	Hardness 硬度	Delivery 交貨日
HTP067	Powdered Highspeed Steel 粉末高速鋼	64~67HRC	8 Working Days 8 個工作日

D Tolerance 柄部直徑公差	
a	m5
b	+0.005 0

Type 品名	D	L (u:10mm)	Jector pin diameter 頂出銷直徑	d1 hole dia 孔徑	d2	d3	S	M	H
HTP067	8	(50)~100	1.4	1.5	3.4	1.5	28	4	13
	10	(50)~100	1.7	1.8	4.4	1.5	28	5	15
	13	(50)~100	2.7	2.8	4.4	1.5	36	5	18
	16	(50)~100	2.7	2.8	4.4	1.5	36	5	21
	20	(50)~100	2.7	2.8	4.4	1.5	36	5	25
	25	(50)~100	3.0	3.1	4.4	1.5	36	5	30

\* L(50) → S=24

Order Ex. 訂購範例

HTP067-8-L-□



外徑  
長度  
柄部直徑公差(a or b)

Alterations	追加加工名稱	Description	加工說明	Order Ex. 訂購範例
LC		Length change 長度變更 $40 \leq LC < L$ *0.1mm increments 指定單位0.1mm		HTP067-8-50-a-LC
LKC LKZ		Full length tolerance change 變更全長公差 LKC → L $\begin{matrix} +0.3 \\ 0 \end{matrix} \rightarrow \begin{matrix} +0.05 \\ 0 \end{matrix}$ LKZ → L $\begin{matrix} +0.3 \\ 0 \end{matrix} \rightarrow \begin{matrix} +0.01 \\ 0 \end{matrix}$		HTP067-8-50-a-LKC
KC		Addition of single key flat to head 頭緣部止迴1面加工		HTP067-8-50-a-KC
WKC		Addition of double key flats in parallel 頭緣平行加工(2面)		HTP067-8-50-a-WKC
AC		The jector pin is removed to create an air path and the side vent hole is plugged from the inside by inserting a resin (ABS) ring. 作為空壓用，將頂出銷拔除，放入環狀樹脂(ABS)從內側將橫孔塞住		HTP067-8-50-a-AC
NC		The jector pin is removed. 拔除頂出銷 * Cannot be combined with AC 不可與AC併用		HTP067-8-50-a-NC